

JEANNEAU SO 379



Jeanneau SO 379 (MAX 6 PERSONS)

Specifications

Design: Mark Lombard.
Length Overall: 11.34 m.
Hull Length: 10.4 m.
Hull Beam: 3.76 m.
Light Displacement: 6700 kg.
Draught: 1.50 m.
Fuel Capacity: 129 l.
Fresh Water Capacity: 200 l.
Engine Power: 29 HP.

Domestic Equipment

Complete Galley
Pressurised Hot & Cold water system.
CD / Stereo
Electric fridge
220v fans

Navigation Equipment

GPS with plotter
Autopilot
VHF
Wind instruments
Log / Speed instruments
Depth sounder
Charts
Bow Thruster

Accommodation

Sleeps: 6
Cabins: 3 Twin.
Heads: 1.
Showers: 1 in head & 1 Cockpit Shower

Rates

Day Charter: €475

Includes:
Exclusive Charter from 09:00 to 18:00
Fuel, Skipper, Taxes and Insurance
Free Flow of water
Boarding from Kalkara Marina
[Menu Optional](#)

Evening Charter: €300

Includes:
Exclusive Charter from 19:00 to 23:00
Fuel, Skipper, Taxes and Insurance
Free Flow of water and soft drinks
Boarding from Kalkara Marina
[Menu Optional](#)

Payment Terms

A Deposit is required to confirm booking. Remaining balance shall be paid in Cash on the day of the charter.
Full Deposit shall be refunded if charter cannot be done due to weather conditions.

BAVARIA 41 Cruiser

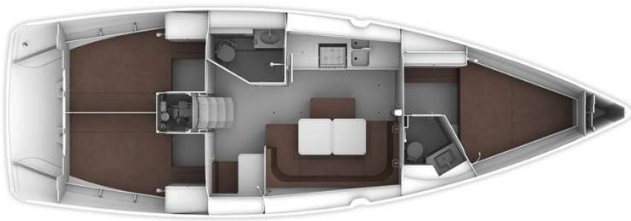

Bavaria 41 Cruiser (MAX 8 PERSONS)

Specifications

Design: Bruce Farr
Length Overall: 12.55 m.
Hull Length: 12.94 m.
Hull Beam: 3.96 m.
Light Displacement: 8680 kg.
Draft: 1.65 m.
Fuel Capacity: 208 l.
Fresh Water Capacity: 208 l.
Engine Power: 45 HP / 33.5 KW.

Domestic Equipment

Complete Galley
Pressurised Hot & Cold water system.
CD / Stereo with Ipod & Blue Tooth connectivity
Electric fridge
12v fans

Navigation Equipment

GPS with plotter
Autopilot
VHF
Wind instruments
Log / Speed instruments
Depth sounder
Charts
Bow Thruster

Accommodation

Sleeps: 6
Cabins: 3 Twin.
Heads: 2.
Showers: 1 in each head & 1 Cockpit Shower

Rates

Day Charter: €497

Includes:

Exclusive Charter from 09:00 to 18:00
Fuel, Skipper, Taxes and Insurance
Free Flow of water
Boarding from Kalkara Marina
Menu Optional

Evening Charter: €350

Includes:

Exclusive Charter from 19:00 to 23:00
Fuel, Skipper, Taxes and Insurance
Free Flow of water and soft drinks
Boarding from Kalkara Marina
Menu Optional

Payment Terms

A Deposit is required to confirm booking. Remaining balance shall be paid in Cash on the day of the charter.
Full Deposit shall be refunded if charter cannot be done due to weather conditions.

BENETEAU CYCLADES 43.3



Beneteau Cyclades 43.3 (MAX 9 PERSONS)

Specifications

Design: Berret-Racoupeau.
Length Overall: 13.26 m.
Hull Length: 12.94 m.
Hull Beam: 4.43 m.
Light Displacement: 8980 kg.
Draft: 1.90 m.
Fuel Capacity: 200 l.
Fresh Water Capacity: 530 l.
Engine Power: 54 HP / 39 KW.
CE Certification: A10 / B11 / C12.

Domestic Equipment

Complete Galley
Pressurised Hot & Cold water system.
CD / Stereo with Ipod connectivity
Electric fridge
220v fans
TV
WIFI

Navigation Equipment

GPS with plotter
Autopilot
VHF
Wind instruments
Log / Speed instruments
Depth sounder
Charts
Bow Thruster

Accommodation

Sleeps: 8
Cabins: 3 Twin.
Heads: 3.
Showers: 1 in each head & 1 Cockpit Shower

Rates

Day Charter: €495

Includes:
Exclusive Charter from 09:00 to 18:00
Fuel, Skipper, Taxes and Insurance
Free Flow of bottled water
Boarding from Kalkara Marina
Menu Optional

Evening Charter: €350

Includes:
Exclusive Charter from 19:00 to 23:00
Fuel, Skipper, Taxes and Insurance
- Fine Cheese and meat platter, Fresh fitra wedges
- Fine Dips and Water Biscuits
- Half Bottle of Wine Per Person
Free Flow of water and soft drinks
Boarding from Kalkara Marina
Menu Optional

Payment Terms

A Deposit is required to confirm booking. Remaining balance shall be paid in Cash on the day of the charter.
Full Deposit shall be refunded if charter cannot be done due to weather conditions.

DUFOUR GRAND LARGE 455



Dufour Grand Large 455 (MAX 10 Persons)

Specifications

Design: Umberto Felci / Patrick Roséo.
Length Overall: 13.76 m.
Hull Beam: 4.3m.
Light Displacement: 10426 kg.
Draft: 2.20m.
Fuel Capacity: 250 l.
Fresh Water Capacity: 530 l.
Engine Power: 75 HP / 55 KW.
CE Certification: Yes

Domestic Equipment

Complete Galley
Pressurised Hot & Cold water system.
CD / Stereo with Ipod connectivity
1 Electric fridge
12v fans in each room and Galley

Navigation Equipment

GPS with plotter
Autopilot
VHF
Wind instruments
Log / Speed instruments
Depth sounder
Charts
Bow Thruster
Electric Halyard winch

Accommodation

Sleeps: 8+2
Cabins: 4 Twin.
Heads: 2.
Showers: 1 in each head & 1 Cockpit Shower

Rates

Day Charter: €550

Includes:
Exclusive Charter from 09:00 to 18:00
Fuel, Skipper, Taxes and Insurance
Free Flow of water
Boarding from Kalkara Marina
Menu Optional

Evening Charter: €375

Includes:
Exclusive Charter from 19:00 to 23:00
Fuel, Skipper, Taxes and Insurance
- Fine Cheese and meat platter, Fresh fitra wedges
- Fine Dips and Water Biscuits
- Half Bottle of Wine Per Person
Free Flow of water and soft drinks
Boarding from Kalkara Marina
Menu Optional

Payment Terms

A Deposit is required to confirm booking. Remaining balance shall be paid in Cash on the day of the charter.
Full Deposit shall be refunded if charter cannot be done due to weather conditions.

BENETEAU CYCLADES 50.5



Beneteau Cyclades 50.5 (MAX 12 PERSONS)

Specifications

Design: Berret-Racoupeau.
Length Overall: 15.65 m.
Hull Beam: 4.9m.
Light Displacement: 8980 kg.
Draft: 2.20m.
Fuel Capacity: 400 l.
Fresh Water Capacity: 1000 l.
Engine Power: 110 HP / 82 KW.
CE Certification: A13 / B14 / C15.

Domestic Equipment

Complete Galley
Pressurised Hot & Cold water system.
CD / Stereo with Ipod connectivity
2 Electric fridges
12v fans

Navigation Equipment

GPS with plotter
Autopilot
VHF
Wind instruments
Log / Speed instruments
Depth sounder
Charts
Bow Thruster

Accommodation

Sleeps: 10+2 plus skipper's cabin
Cabins: 5 Twin.
Heads: 3.
Showers: 1 in each head & 1 Cockpit Shower

Rates

Day Charter: €625

Includes:

Exclusive Charter from 09:00 to 18:00
Fuel, Skipper, Taxes and Insurance
Free Flow of water
Boarding from Kalkara Marina
Menu Optional

Evening Charter: €450

Includes:

Exclusive Charter from 19:00 to 23:00
Fuel, Skipper, Taxes and Insurance
- Fine Cheese and meat platter, Fresh fitra wedges
- Fine Dips and Water Biscuits
- Half Bottle of Wine Per Person
Free Flow of water and soft drinks
Boarding from Kalkara Marina
Menu Optional

Payment Terms

A Deposit is required to confirm booking. Remaining balance shall be paid in Cash on the day of the charter.
Full Deposit shall be refunded if charter cannot be done due to weather conditions.

Beneteau Cyclades 50.5 (MAX 15 PERSONS)

Specifications

Design: Berret-Racoupeau.
Length Overall: 15.65 m.
Hull Beam: 4.9m.
Light Displacement: 8980 kg.
Draft: 2.20m.
Fuel Capacity: 400 l.
Fresh Water Capacity: 1000 l.
Engine Power: 110 HP / 82 KW.
CE Certification: A13 / B14 / C15.

Domestic Equipment

Complete Galley
Pressurised Hot & Cold water system.
CD / Stereo with Ipod connectivity
2 Electric fridges
12v fans

Navigation Equipment

GPS with plotter
Autopilot
VHF
Wind instruments
Log / Speed instruments
Depth sounder
Charts
Bow Thruster

Accommodation

Sleeps: 10+2 plus skipper's cabin
Cabins: 5 Twin.
Heads: 3.
Showers: 1 in each head & 1 Cockpit Shower

Rates

Day Charter: €750

Includes:

Exclusive Charter from 09:00 to 18:00
Fuel, Skipper, Taxes and Insurance
Free Flow of water
Boarding from Kalkara Marina
Menu Optional

Evening Charter: €550

Includes:

Exclusive Charter from 19:00 to 23:00
Fuel, Skipper, Taxes and Insurance
- Fine Cheese and meat platter, Fresh fitra wedges
- Fine Dips and Water Biscuits
- Half Bottle of Wine Per Person
Free Flow of water and soft drinks
Boarding from Kalkara Marina
Menu Optional

Payment Terms

A Deposit is required to confirm booking. Remaining balance shall be paid in Cash on the day of the charter.
Full Deposit shall be refunded if charter cannot be done due to weather conditions.